

ITEM AT10

MATERIAL SPECIFICATIONS

WORKTOPS - 1.5mm 304 GRADE ST ST  
FRAMEWORK - 30 x 30 BOX SECTION 430 GRADE ST ST  
UNDERSHELVES - 1.2mm 430 GRADE ST ST  
OVERSHELVES - 1.2mm 430 GRADE ST ST  
FEET - ADJUSTABLE FLANGED (CAST ALUMINIUM)  
PANELWORK - 0.9mm 430 GRADE ST ST

Supplied with nutsert fixings to each  
hole for fixing to adjacent BarCED units

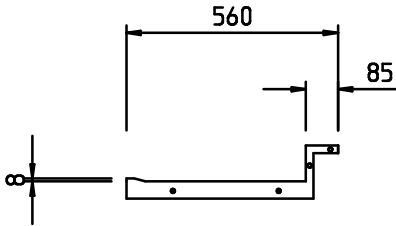
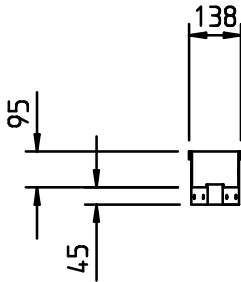
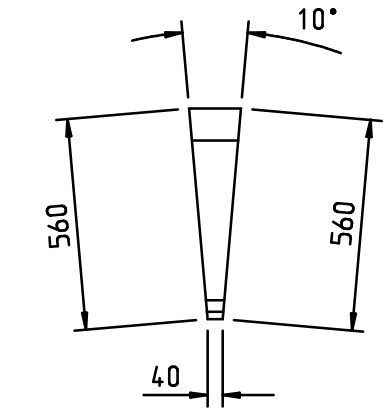

VIEW ON END  
PROFILE

PLEASE CONFIRM THERE IS SUITABLE ACCESS TO SITE FOR DELIVERY OF THIS ITEM

APPROVED FOR  
MANUFACTURE

Signature..... Date..... Print.....

DO NOT SCALE DRAWING

CUST Ref:

REV  
No

REVISION

DATE

TOLERANCE TABLE

1	± 2mm
1.0	± 0.5mm
1.00	± 0.2mm

UNLESS STATED OTHERWISE



CED FABRICATIONS LTD  
A1-A4 FALCON COURT  
PETRE ROAD  
CLAYTON-LE-MOORS  
HYNDBURN  
LANCASHIRE BB5 5JD

This drawing and information herein is confidential to  
CED Fabrications Ltd. It is issued in confidence that  
it will not be disclosed to any third party in part or  
in whole without permission from CED FABRICATIONS Ltd.

© 1999 CED FABRICATIONS LTD

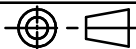

TITLE : AT10 BarCED ANGLED TOP 10 DEGREE

REV No:

DRAWN BY:

CUST O/No:

DRG No: **AT10**

DATE: 15/06/2016 17:00:59

SCALE: 1:20 (A4)