

ITEM PB65

MATERIAL SPECIFICATIONS

WORKTOPS - 1.5mm 304 GRADE ST ST
 FRAMEWORK - 30 x 30 BOX SECTION 430 GRADE ST ST
 UNDERSHELVES - 1.2mm 430 GRADE ST ST
 OVERSHELVES - 1.2mm 430 GRADE ST ST
 FEET - ADJUSTABLE FLANGED (CAST ALUMINIUM)
 PANELWORK - 0.9mm 430 GRADE ST ST

Supplied with nutsert fixings to each
 hole for fixing to adjacent BarCED units

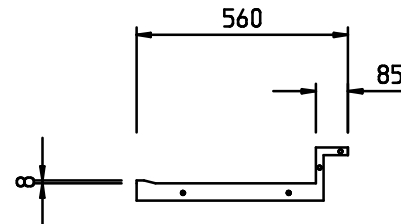
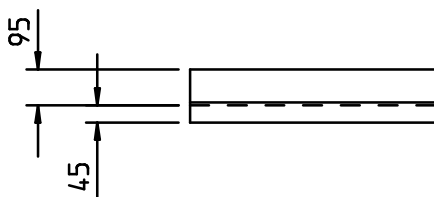
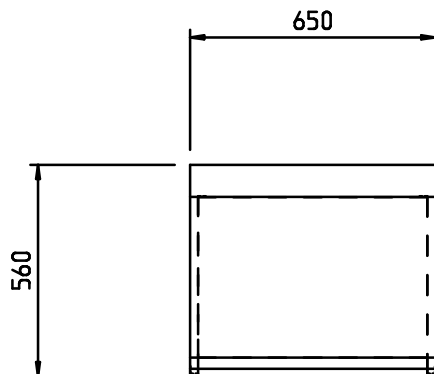

PLEASE CONFIRM THERE IS SUITABLE ACCESS TO SITE FOR DELIVERY OF THIS ITEM

APPROVED FOR
 MANUFACTURE

Signature..... Date..... Print.....

DO NOT SCALE DRAWING

CUST Ref:

REV
 No

REVISION

DATE

TOLERANCE TABLE

1	± 2mm
1.0	± 0.5mm
1.00	± 0.2mm

UNLESS STATED OTHERWISE



CED FABRICATIONS LTD
 A1-A4 FALCON COURT
 PETRE ROAD
 CLAYTON-LE-MOORS
 HYNDURN
 LANCASHIRE BB5 5JD

This drawing and information herein is confidential to
 CED Fabrications Ltd. It is issued in confidence that
 it will not be disclosed to any third party in part or
 in whole without permission from CED FABRICATIONS Ltd.

© 1999 CED FABRICATIONS LTD

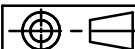

TITLE: PB65 BarCED PLAIN TOP BRIDGING WORKTOP 650

REV No:

DRAWN BY:

CUST O/No:

DRG No: **PB65**

DATE: 15/06/2016 16:45:29

SCALE: 1:20 (A4)