

PLAN VIEW

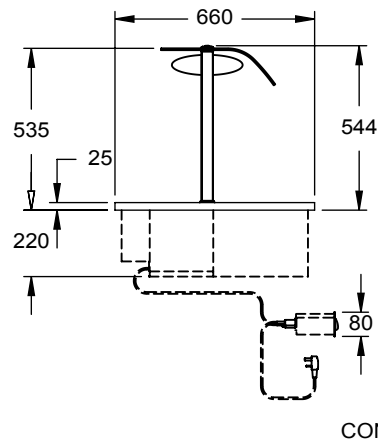

END VIEW

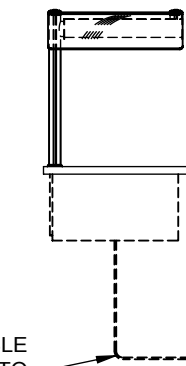

FRONT VIEW
(CUSTOMER SIDE)

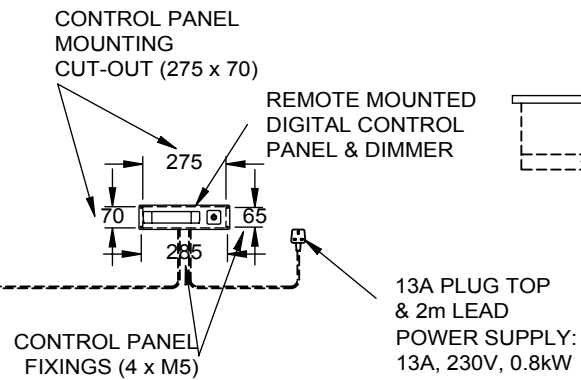

REAR VIEW
(OPERATOR SIDE)

APPROX. UN-CRATED
WEIGHT OF UNIT: 22Kg



CED FABRICATIONS LTD
UNITS A1-A4, FALCON COURT
CLAYTON BUSINESS PARK
CLAYTON-LE-MOORS
HYNDBURN
LANCASHIRE BB5 5JD

This drawing and information herein is confidential to CED Fabrications Ltd.
It is issued in confidence that it will not be disclosed to any third party in part or in whole without permission from CED FABRICATIONS Ltd.

© CED FABRICATIONS LTD

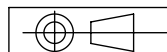

DESCRIPTION:

DESIGNLINE DROP-IN HEATED
1-1 GN BAIN MARIE (DRY HEAT)

SCALE: 1 : 25 @ A4

REV No:

PRODUCT
CODE:

HBM1