

FINISHES:  
MAIN STUCTURE: STAINLESS STEEL  
FOOD SAFE POWDER COATED BLACK (RAL 9005)  
ALTERNATIVE RAL COLOUR OPTION (DCOL2)  
END GLASS: 6m CLEAR TOUGHENED  
WIRE GRIDS: 304 GRADE STAINLESS STEEL

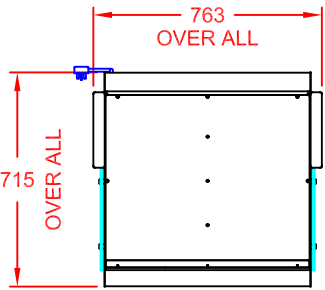

PLAN VIEW

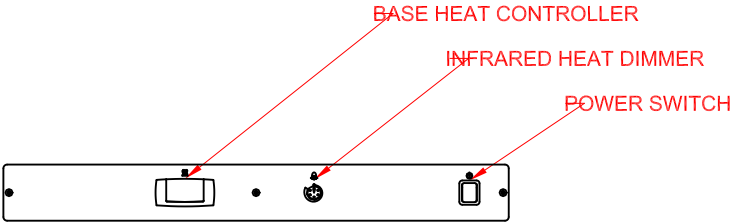

CONTROL PANEL DETAIL

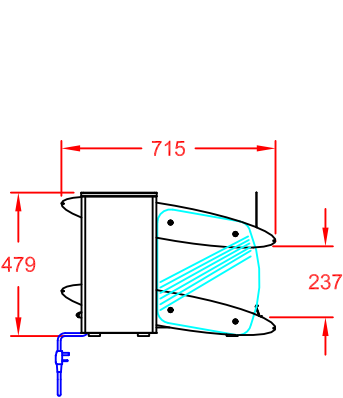

END VIEW

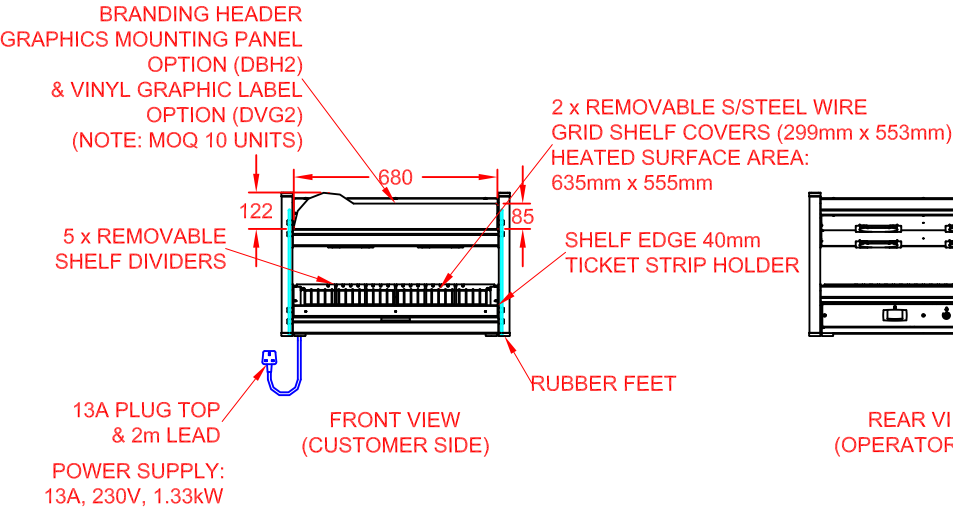

FRONT VIEW  
(CUSTOMER SIDE)

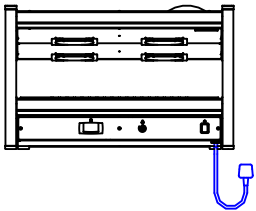

REAR VIEW  
(OPERATOR SIDE)

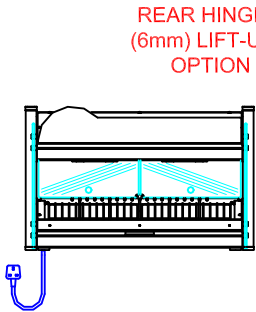

FRONT VIEW  
(CUSTOMER SIDE)  
c/w REAR DOOR OPTION

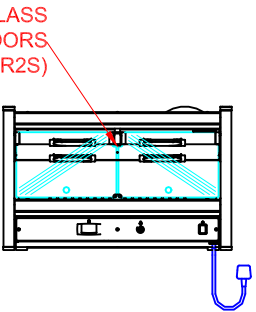

REAR VIEW  
(OPERATOR SIDE)  
c/w REAR DOOR OPTION

APPROX. UN-CRATED  
WEIGHT OF UNIT: 31Kg



CED FABRICATIONS LTD  
UNITS A1-A4, FALCON COURT  
CLAYTON BUSINESS PARK  
CLAYTON-LE-MOORS  
HYNDBURN  
LANCASHIRE BB5 5JD

This drawing and information herein is confidential to CED Fabrications Ltd. It is issued in confidence that it will not be disclosed to any third party in part or in whole without permission from CED FABRICATIONS Ltd.

© CED FABRICATIONS LTD

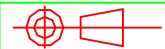

DESCRIPTION:

DESIGNLINE SINGLE TIER  
2-1 Gn TABLE TOP HEATED  
MERCHANDISER  
c/w ALL OPTIONS

SCALE: 1 : 2.5 @ A4 REV No:

PRODUCT  
CODE: DTTHM2S