

### A) WORKTOP CUT-OUT

Model Ref.	Worktop Cut Out Size (mm)		Model Weight (in Kg)
	Length	Width	
SHBM2AS	795	650	48
SHBM3AS	1145	650	58
SHBM4AS	1495	650	69
SHBM5AS	1845	650	80

FIX LIFTING BRACKETS TO FRAME END FLANGES USING SCREWS ALREADY IN FLANGES, THEN LOCATE LIFTING BARS INTO SQUARE HOLES.

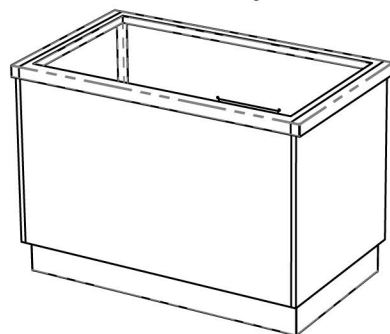
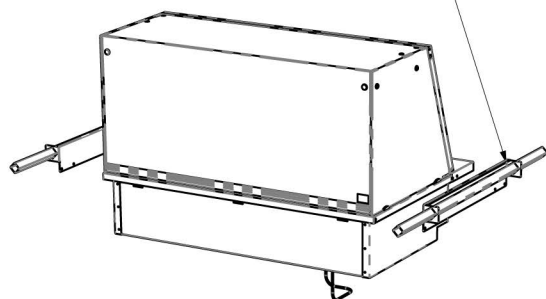

**FRONT ISOMETRIC**  
(CUSTOMER SIDE)

### B) FITTING INTO COUNTER WORKTOP

SILICON SEAL AROUND DISPLAY FLANGE TO COUNTER WORKTOP

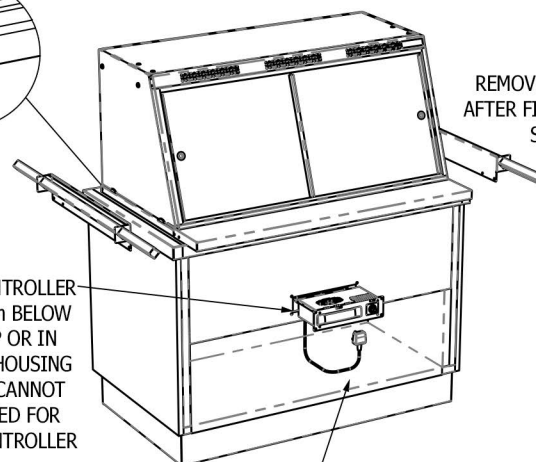
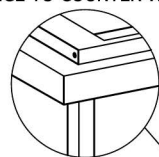

LOCATE CONTROLLER MIN. 300mm BELOW WORKTOP OR IN ADJACENT HOUSING IF 215mm CANNOT BE ALLOWED FOR BEHIND CONTROLLER

CONTROLLER UNIT FITTED WITH 2m LEAD & 13A PLUG \*

**REAR ISOMETRIC**  
(OPERATOR SIDE)

DO NOT SITE CONTROL PANEL ABOVE HEAT SOURCE OVER 40°C  
i.e. UNINSULATED HOT CUPBOARDS

### C) CONNECTIONS TO CONTROLLER UNIT

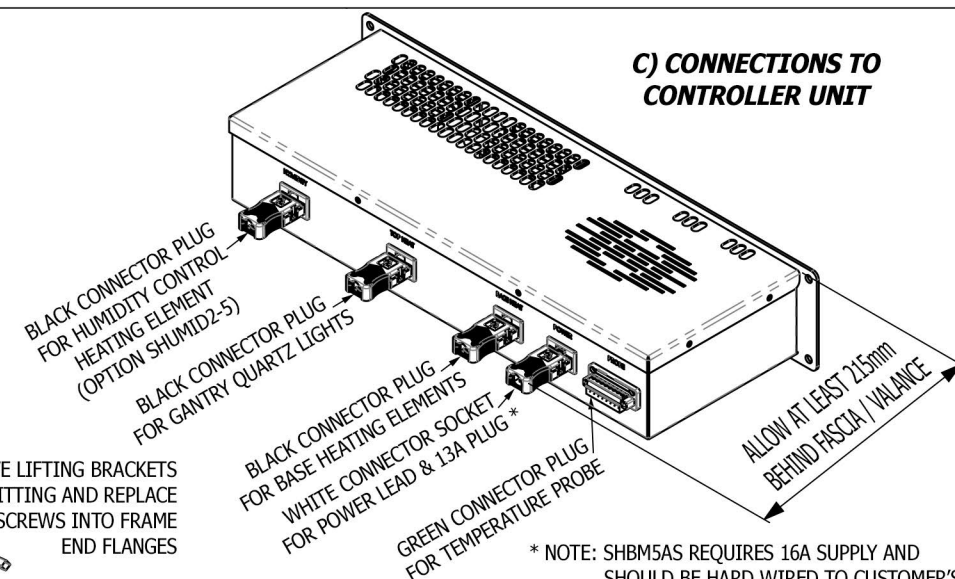

### D) CONTROLLER UNIT MOUNTING DETAILS

