

**NOTE:** THE FROST TOP IS PRE FACTORY SET TO ACHIEVE TEMPERATURES BETWEEN -8 TO -10°C WHICH IS THE OPTIMUM TEMPERATURE FOR PRODUCING FROST ON THE WORKTOP. PLEASE CHECK WITH WORKTOP MANUFACTURER THAT THE MATERIAL IS ABLE TO PERFORM WITH IN THIS TEMPERATURE RANGE.

## INSTALLATION NOTES:

- TEMPERATURE TRANSFER COMPOUND ( SUPPLIED BY CED ) TO BE APPLIED EVENLY IN BETWEEN SOLID SURFACE AND FROST TOP
- ( iii ) SILICONE NOT TO BE USED
- ADEQUATE DUCTING REQUIRED FOR CORRECT AIR CIRCULATION ( BY OTHERS ).
- ELECTRICAL LOAD 3.0kw / 13amp.
- UNIT SUPPLIED WITH 13A PLUG AND TWO METERS LONG CABLE
- GAS CHARGE 0.17 KG ( R290 ).

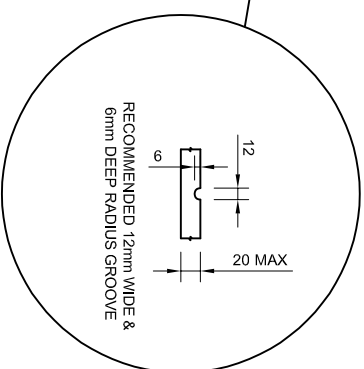
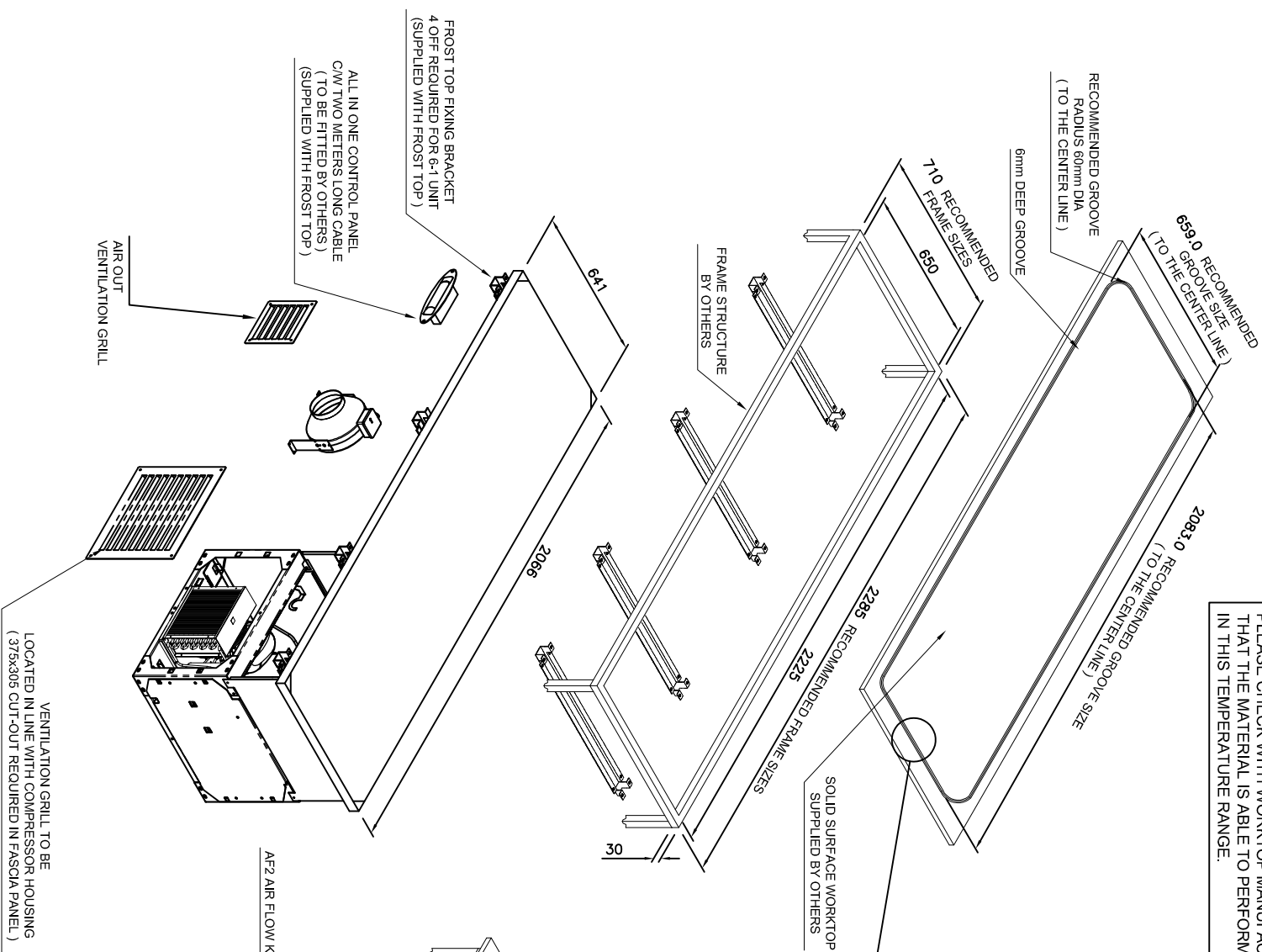

## Isometric View

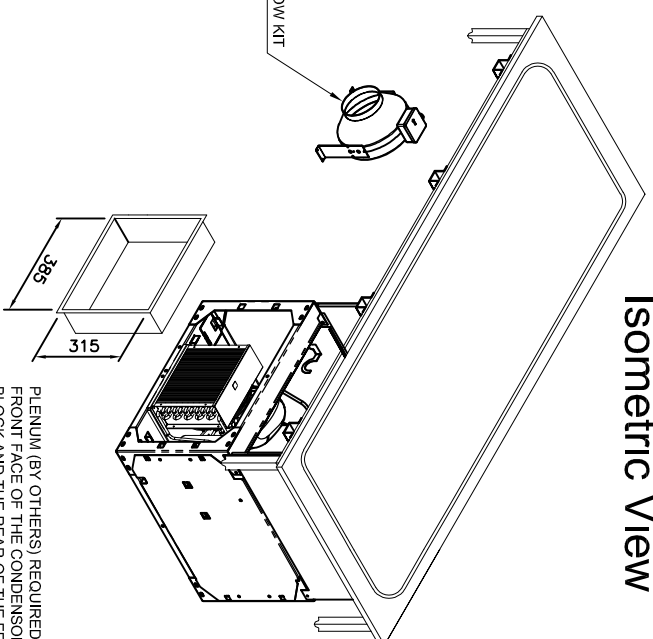

## CONTROL PANEL

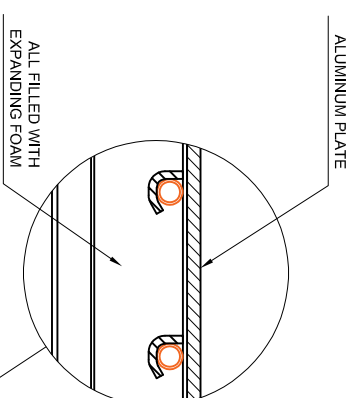
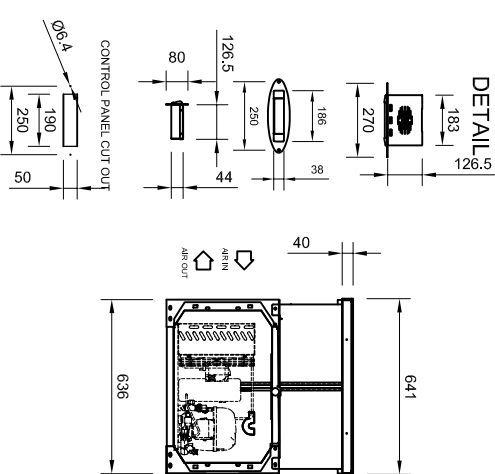

## ALTERNATE FASCIA PANEL ROUTING

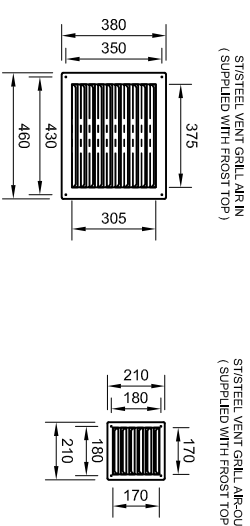
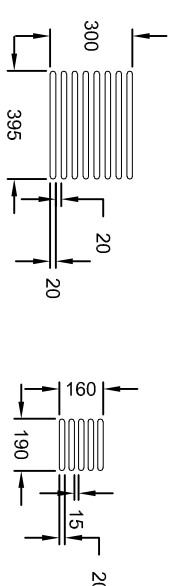

# 6-1 Frost Top + AF2 KIT

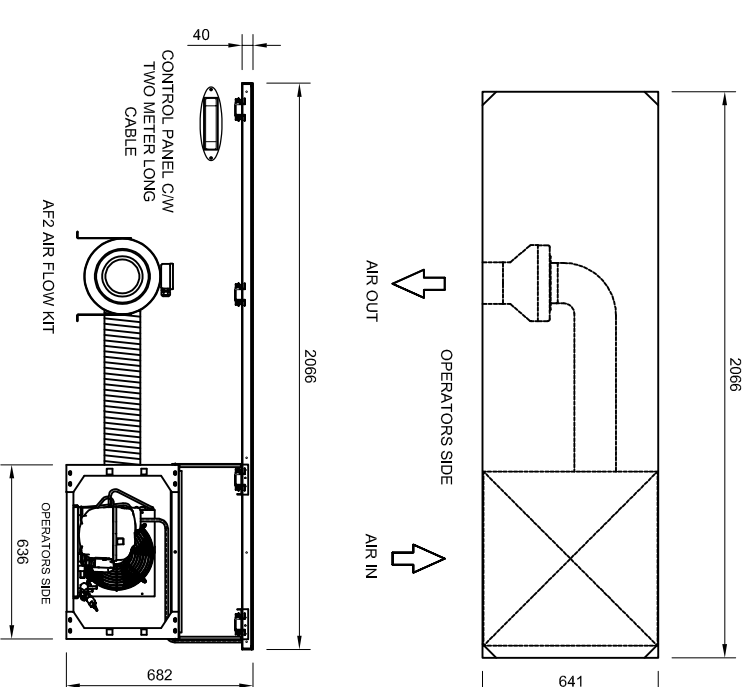

TOLERANCE TABLE		Part No	REVISION DETAILS	DATE
1	± 2mm	—	—	—
1.0	± 0.5mm	—	—	—
SITE: VIRGIN LOUNGE		—	—	—
CLIENT: CATERING PROJECTS		TITLE: 6-1 FROST TOP		
DRAWN BY: IWS		ORDER No:	9854	DRG No: 236466
SCALE: 1:16 @ A2		DATE:	16/03/2020	