

PLAN VIEW

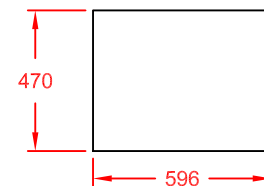

OPTIONAL FRONT FASCIA PANELS
KABF6 - BLACK EPOXY COATED STEEL
KASF6 - SATIN STAINLESS STEEL
FOR FREE STANDING MODELS

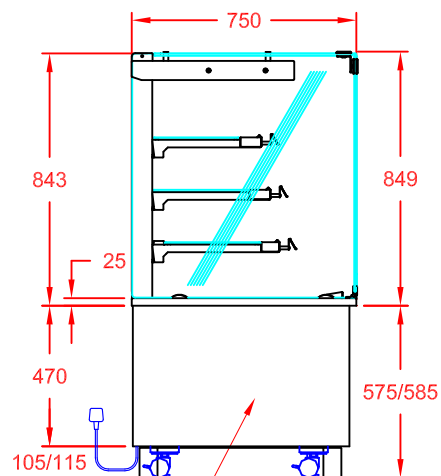

END VIEW

SIDE PANELS & TOP
REAR CANOPY IN BLACK
EPOXY COATED STEEL
AS STANDARD
OR OPTION KASB6 - SATIN
STAINLESS STEEL PANELS

13A PLUG TOP
& 2m LEAD
POWER SUPPLY:
13A, 230V, 0.1kW

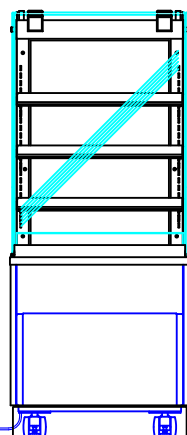

FRONT VIEW
(CUSTOMER SIDE)

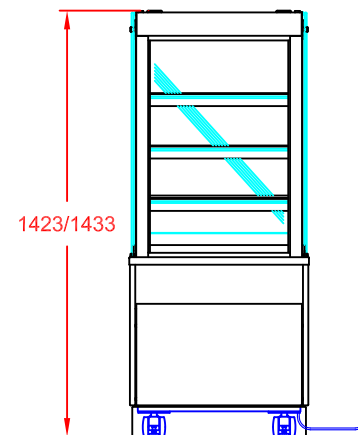

REAR VIEW
(OPERATOR SIDE)

APPROX. UN-CRATED
WEIGHT OF UNIT: 110Kg



CED FABRICATIONS LTD
UNITS A1-A4, FALCON COURT
CLAYTON BUSINESS PARK
CLAYTON-LE-MOORS
HYNDBURN
LANCASHIRE BB5 5JD

This drawing and information herein is confidential to CED Fabrications Ltd.
It is issued in confidence that it will not be disclosed to any third
party in part or in whole without permission from CED FABRICATIONS Ltd.

© CED FABRICATIONS LTD

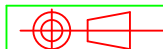

DESCRIPTION:

CABINET KUBUS PATISSERIE
600mm ASST SERV AMB - OPEN REAR

SCALE: 1 : 25 @ A4 REV No: A

PRODUCT
CODE:

KPA6AS