

PLAN VIEW

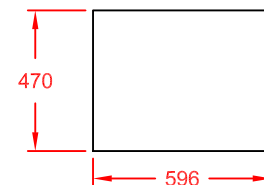

OPTIONAL FRONT FASCIA PANELS  
KABF6 - BLACK EPOXY COATED STEEL  
KASF6 - SATIN STAINLESS STEEL  
FOR FREE STANDING MODELS

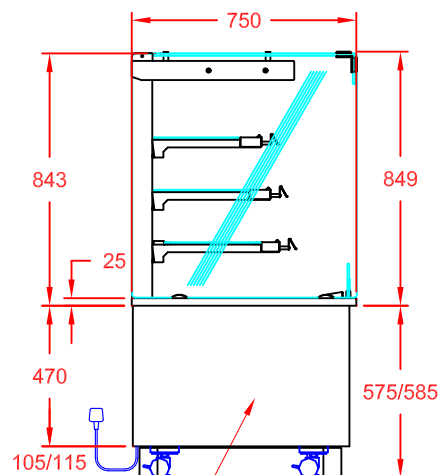

END VIEW

SIDE PANELS & TOP  
REAR CANOPY IN BLACK  
EPOXY COATED STEEL  
AS STANDARD  
OR OPTION KASB6 - SATIN  
STAINLESS STEEL PANELS

13A PLUG TOP  
& 2m LEAD  
POWER SUPPLY:  
13A, 230V, 0.1kW

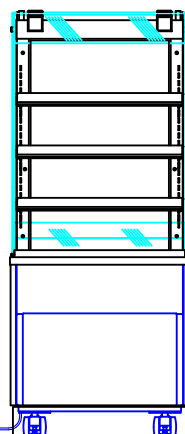

FRONT VIEW  
(CUSTOMER SIDE)

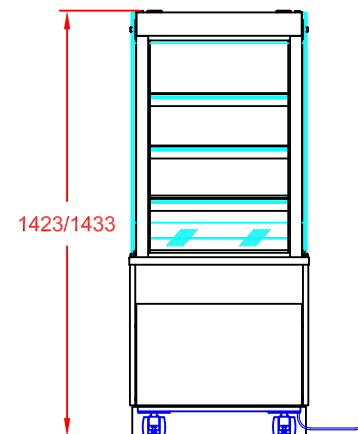

REAR VIEW  
(OPERATOR SIDE)

APPROX. UN-CRATED  
WEIGHT OF UNIT: 110Kg



CED FABRICATIONS LTD  
UNITS A1-A4, FALCON COURT  
CLAYTON BUSINESS PARK  
CLAYTON-LE-MOORS  
HYNDBURN  
LANCASHIRE BB5 5JD

This drawing and information herein is confidential to CED Fabrications Ltd. It is issued in confidence that it will not be disclosed to any third party in part or in whole without permission from CED FABRICATIONS Ltd.

© CED FABRICATIONS LTD

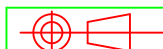

## DESCRIPTION:

CABINET KUBUS PATISSERIE  
600mm SELF HELP AMB - OPEN REAR

SCALE: 1 : 25 @ A4 REV No: A

PRODUCT  
CODE:

KPA6