

PLAN VIEW

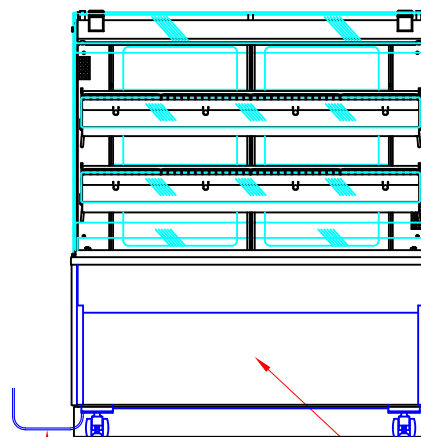

FRONT VIEW  
(CUSTOMER SIDE)

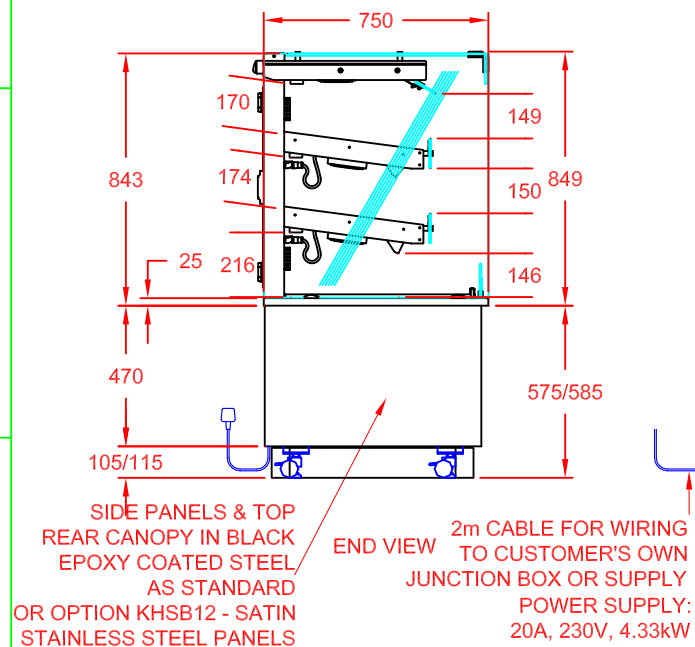
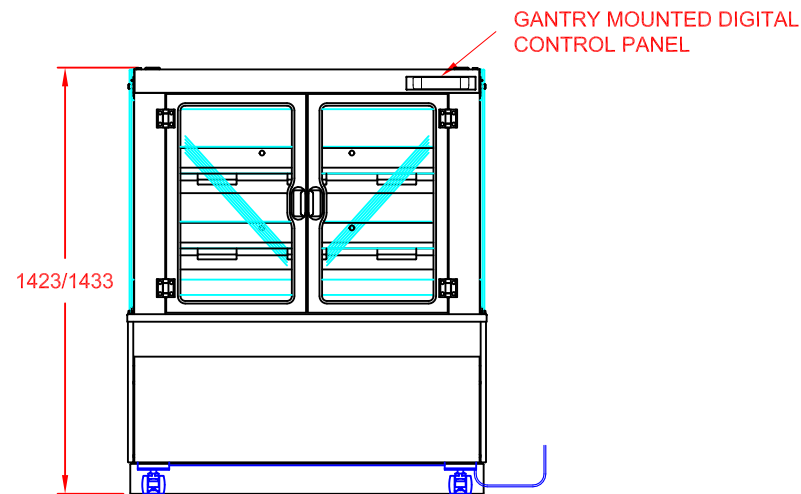

REAR VIEW  
(OPERATOR SIDE)

OPTIONAL FRONT FASCIA PANELS  
KABF12 - BLACK EPOXY COATED STEEL  
KASF12 - SATIN STAINLESS STEEL  
FOR FREE STANDING MODELS

APPROX. UN-CRATED  
WEIGHT OF UNIT: 215Kg

## DESCRIPTION:

CABINET KUBUS PATISSERIE  
1200mm SELF HELP HEATED-REAR DOORS

SCALE: 1 : 25 @ A4 REV No: A

PRODUCT  
CODE:

KPH12



CED FABRICATIONS LTD  
UNITS A1-A4, FALCON COURT  
CLAYTON BUSINESS PARK  
CLAYTON-LE-MOORS  
HYNDBURN  
LANCASHIRE BB5 5JD

This drawing and information herein is confidential to CED Fabrications Ltd. It is issued in confidence that it will not be disclosed to any third party in part or in whole without permission from CED FABRICATIONS Ltd.

© CED FABRICATIONS LTD

