

MERCHANDISER REQUIRES A MINIMUM VENTILATION VOID OF 100mm ABOVE AND 50mm BEHIND UNIT FOR HEAT TO ESCAPE.

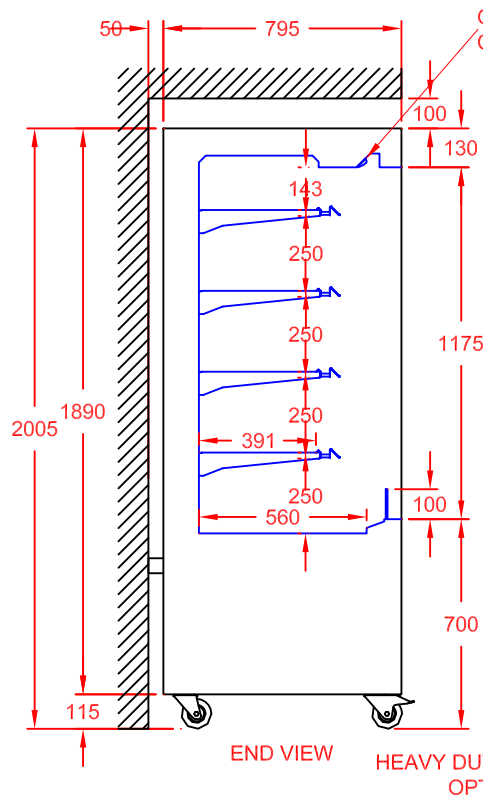

HEAVY DUTY CASTOR  
OPTION HDC18

GANTRY MOUNTED DIGITAL  
CONTROL PANEL

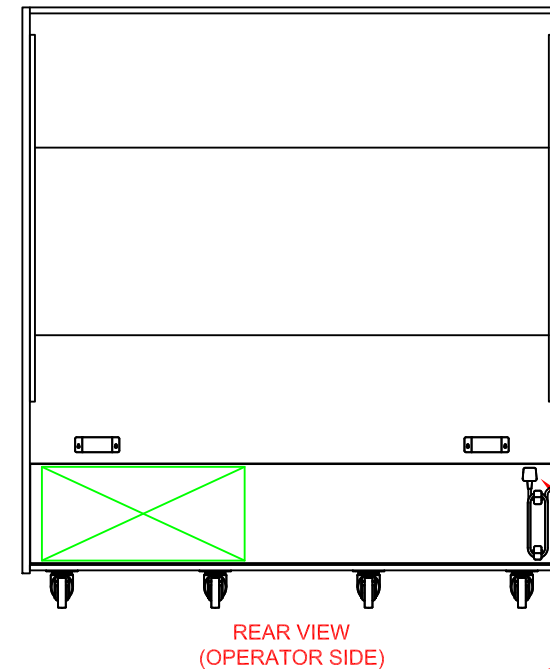
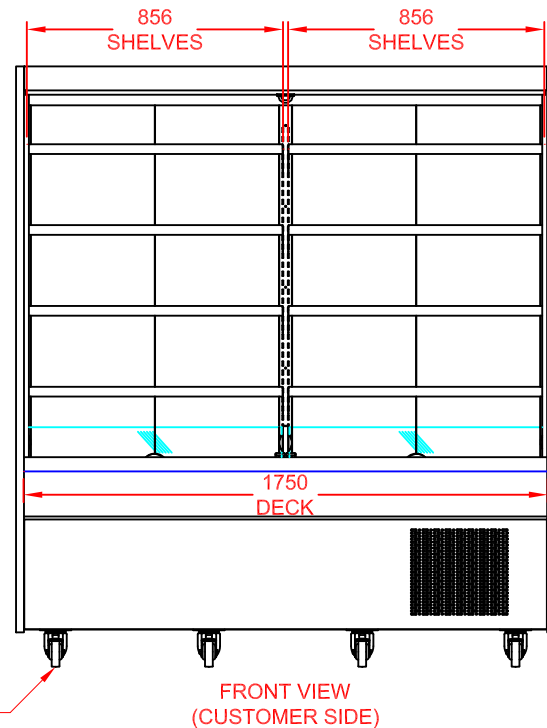

POWER SUPPLY:  
13A, 230V, 1.72kW

CAPACITY: 862L

APPROX. UN-CRATED  
WEIGHT OF UNIT: 349Kg

#### Ventilation / Display Performance Considerations

- 1) Area in which display is to be sited must have a minimum room floor area no less than 33 sq m.
- 2) Install over a sealed floor or ventilated floor void.
- 3) Do not site the display within 2m of ceiling mounted air conditioning grilles.
- 4) Do not site the display beneath a high level of direct sunlight.
- 5) Display will operate in a 24 hour environment.



CED FABRICATIONS LTD  
UNITS A1-A4, FALCON COURT  
CLAYTON BUSINESS PARK  
CLAYTON-LE-MOORS  
HYNDBURN  
LANCASHIRE BB5 5JD

This drawing and information herein is confidential to CED Fabrications Ltd. It is issued in confidence that it will not be disclosed to any third party in part or in whole without permission from CED FABRICATIONS Ltd.

© CED FABRICATIONS LTD



#### DESCRIPTION:

MONEY MAKER CHILLED MERCHANDISER  
1800mm 4 TIER LARGE (NIGHT BLIND)  
HYDROCARBON TYPE-R290 REFRIGERANT

SCALE: 1 : 25 @ A4 REV No: B

PRODUCT CODE: MM1800LHT+HDC18