

### Ventilation / Display Performance Considerations

- 1) Area in which display is to be sited must have a minimum room floor area no less than 26 sq m.
- 2) Install over a sealed floor or ventilated floor void.
- 3) Do not site the display within 2m of ceiling mounted air conditioning grilles.
- 4) Do not site the display beneath a high level of direct sunlight.
- 5) Display will operate in a 24 hour environment.

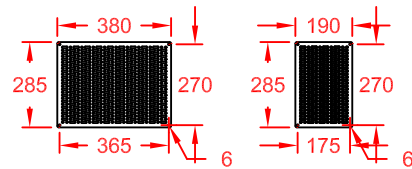

REMOVABLE FASCIA GRILLES  
(1x EACH SUPPLIED FIXED TO FRONT OF UNIT)

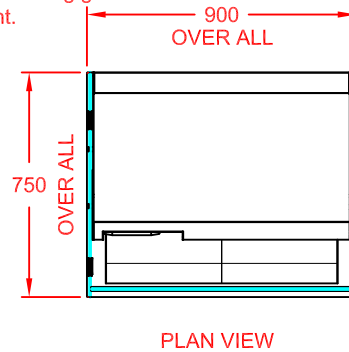

PLAN VIEW

### GANTRY MOUNTED DIGITAL CONTROL PANEL

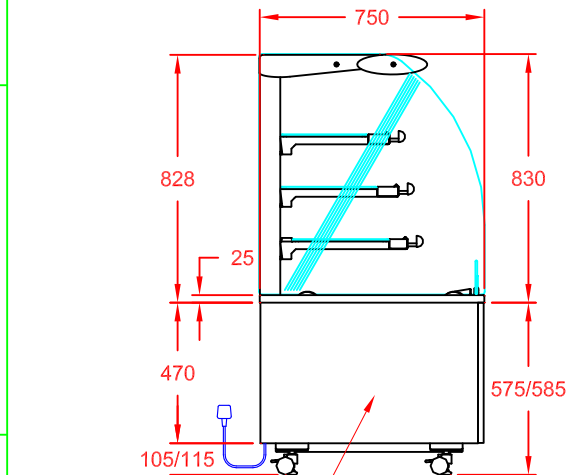

SIDE & FRONT FASCIA PANELS IN BLACK PLASTISOL AS STANDARD.  
OPTIONAL SATIN ST/STL:  
KSSP = SIDE PANELS,  
KCSF9 = FRONT PANEL

END VIEW

13A PLUG TOP & 3m LEAD  
POWER SUPPLY:  
13A, 230V, 1.54kW

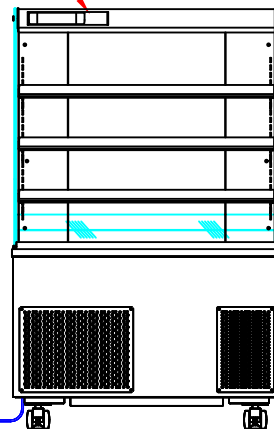

FRONT VIEW  
(CUSTOMER SIDE)

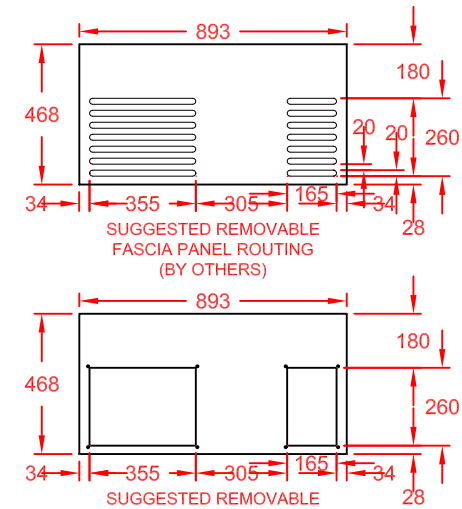

SUGGESTED REMOVABLE FASCIA PANEL ROUTING  
(BY OTHERS)  
SUGGESTED REMOVABLE FASCIA PANEL CUT OUT  
(BY OTHERS)  
FOR MOUNTING FASCIA GRILLES

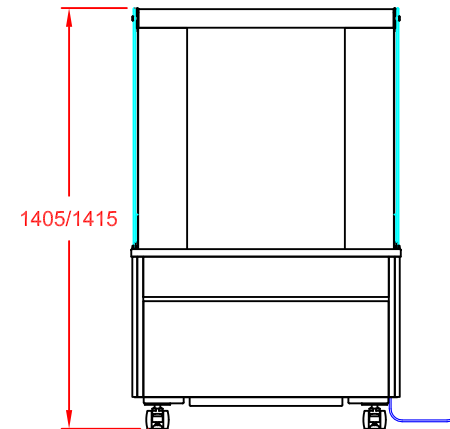

REAR VIEW  
(OPERATOR SIDE)

APPROX. UN-CRATED  
WEIGHT OF UNIT: 188Kg



CED FABRICATIONS LTD  
UNITS A1-A4, FALCON COURT  
CLAYTON BUSINESS PARK  
CLAYTON-LE-MOORS  
HYNDBURN  
LANCASHIRE BB5 5JD

This drawing and information herein is confidential to CED Fabrications Ltd. It is issued in confidence that it will not be disclosed to any third party in part or in whole without permission from CED FABRICATIONS Ltd.

© CED FABRICATIONS LTD

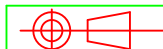

### DESCRIPTION:

DESIGNLINE PATISSERIE  
900mm SELF HELP COLD - FIXED BACK  
HYDROCARBON TYPE-R290 REFRIGERANT

SCALE: 1 : 2.5 @ A4 REV No: B

PRODUCT  
CODE:

PC9FBHT