



Designline Serve Over Cold Patisserie



900mm Self Help Cold Patisserie (Fixed Back) Shown (Airflow In/Out Customer Side)



900mm Self Help Cold Patisserie (Rear Doors) Shown (Airflow In/Out Operator Side)

ABOUT

The energy efficient, environmentally friendly fan blown cold patisserie is part of the Designline range of freestanding serve over height patisseries - a choice of cold, hot & ambient commercial displays to suit either self help or assisted service retail operations.

The cold serve over circulates a constant stream of cold air throughout the display area, maintaining pre-chilled food between 2- 5 degrees C, just right for your fruit and vegetables, sandwiches, yoghurts, salads and cold drinks.

This mobile self contained display is available in five different lengths, with locking, adjustable height levelling castors to easily position the equipment around your serving space. The display comprises four chilled display levels each illuminated by LED lighting.

Digital temperature control, auto defrost & the auto condensate evaporation tray allow 24 hour operation if required. All Designline cold patisseries use a highly efficient, naturally occurring hydrocarbon refrigerant gas within hermetically sealed condensing units, which reduce energy consumption and your carbon footprint !

OPTIONS & FINISHES

Stainless Steel Front Fascia Panel

A ventilated or solid satin steel panel to suit particular model, in lieu of standard black panel.

Stainless Steel Side Panels (Pair)

A set of satin s/steel finish side panels, in lieu of standard black sides.

ACCESSORIES

Kickplinth (Set)

A magnet mounted set of s/steel kickplinths



FEATURES

Download All Technical Drawings From www.cedfabsltd.co.uk

Model Sizes.

The Designline self help or assisted service cold patisserie is an open or closed glass front cold patisserie, available in 600mm, 900mm, 1200mm, 1500mm & 1800mm lengths.

3 Tier Shelving & Deck Storage Capacity.

The display features 3 chilled glass shelves (adjustable in height & angle) & chilled s/ steel bottle storage deck below. The toughened glass shelving has product stops & 40mm(h) ticket strip holder to the front edge of each shelf.

LED Lighting.

Canopy & shelf lighting in a low energy LED fitting with opaque cover, colour 4000k.

Model Type: Self Help Cold Patisserie (Rear Doors).

Re-stocking access is by energy efficient, side hinged double glazed rear doors.

Cold Airflow: In Customer/ Out Operator (600mm) In/ Out Operator Side (Other Sizes)

Model Type: Self Help Cold Patisserie (Fixed Back).

This cold patisserie is supplied as wall sited with front control panel and stainless steel back panel for positioning in an alcove, against a wall or back to back, forming a central island grab and go station !

Cold Airflow: In Customer/ Out Operator c/w Wall Stand Off Bracket (600mm) In/ Out Customer Side (Other Sizes)

Model Type: Assisted Service Cold Patisserie (Rear Doors).

Features a full glazed front screen that tilts forward for cleaning. Re-stocking access is through the energy efficient, side hinged double glazed rear doors.

Cold Airflow: In Customer/ Out Operator (600mm) In/ Out Operator Side (Other Sizes)

Panoramic Glass Sides & Serve Over Top Steel Panel.

Flat steel top panel allows for serve over operation & side glass panels add natural lighting.

Model Dimensions.

600mm/ 900mm/ 1200mm/ 1500mm & 1800mm (L) x 750mm (D) x 1405/ 1415mm (H).

Refrigeration Type.

Fan blown, hydrocarbon r290 energy efficient refrigeration.

System Design.

Auto defrost with 24 hour operation & digital temperature control.

Temperature Performance.

0°C to 5°C (max 27°C ambient 55% humidity).

Auto Drip Tray.

Integral auto evaporator condensate drip tray (float & micro switch).

Finishes.

Base panels finish plastisol steel, colour black (BS 00E53). Worktop & rear frame 430gd s/steel, deck area 304gd s/steel, toughened glass shelving.

Power Supply.

Supplied with 3m lead & 13 amp UK plug (13A 230v 50Hz).

Environmental Benefits.

Hydrocarbon refrigeration system (r290) has low global warming potential (GWP) & zero ozone depletion potential (ODP)

Equipment Conformity.

CE & UKCA Certified equipment.

Self Help Cold Patisserie (Rear Doors)

Code	Description	Dimensions (L x D x H mm)	Refrig. Airflow Air In/Out	Weight (kg)	Power Rating (kW)
PC6HT	Designline S.Help Cold Patiss. (R.Doors) 600mm	600 x 750 x 1405	In Customer/ Out Operator	141	1.32
PC9HT	Designline S.Help Cold Patiss. (R.Doors) 900mm	900 x 750 x 1405	In Operator/ Out Operator	188	1.54
PC12HT	D.line S.Help Cold Patiss. (R.Doors) 1200mm	1200 x 750 x 1405	In Operator/ Out Operator	240	1.68
PC15HT	D.line S.Help Cold Patiss. (R.Doors) 1500mm	1500 x 750 x 1405	In Operator/ Out Operator	294	1.71
PC18HT	D.line S.Help Cold Patiss. (R.Doors) 1800mm	1800 x 750 x 1405	In Operator/ Out Operator	346	1.76

Model Description. Designline self help cold patisserie, rear doors, 6/9/12/15/1800 (l) x 750(d) x 1405/1415 (h), chilled glass shelves (3) c/w ticket strips, chilled deck area (1), fan blown, hydrocarbon r290 energy efficient refrigeration, LED lighting each tier, colour 4000k. Automatic defrost, 24 hour operation, auto evaporator condensate tray, glazed curved side panels & d/ glazed rear doors. Front/side base panels in steel plastisol, colour black (BS 00E53). Controls to operator side. Lift off rear service panel, lockable adj. height castors, 3m lead, 13A 230v UK plug.

Self Help Cold Patisserie (Fixed Back)

Code	Description	Dimensions (L x D x H mm)	Refrig. Airflow Air In/Out	Weight (kg)	Power Rating (kW)
PC6FBHT	Designline S.Help Cold Patiss. (F.Back) 600mm	600 x 750 +75 x 1405	In Customer/ Out Operator	141	1.32
PC9FBHT	Designline S.Help Cold Patiss. (F.Back) 900mm	900 x 750 x 1405	In Customer/ Out Customer	188	1.54
PC12FBHT	D.line S.Help Cold Patiss. (F.Back) 1200mm	1200 x 750 x 1405	In Customer/ Out Customer	240	1.68
PC15FBHT	D.line S.Help Cold Patiss. (F.Back) 1500mm	1500 x 750 x 1405	In Customer/ Out Customer	294	1.71
PC18FBHT	D.line S.Help Cold Patiss. (F.Back) 1800mm	1800 x 750 x 1405	In Customer/ Out Customer	346	1.76

Model Description. Designline self help cold patisserie, fixed rear back panel (wall sited), 6/9/12/15/1800 (l) x 750(d) x 1405/1415 (h), chilled glass shelves (3) c/w ticket strips, chilled deck area (1), fan blown, hydrocarbon r290 energy efficient refrigeration, LED lighting each tier, colour 4000k. Automatic defrost, 24 hour operation, auto evaporator condensate tray, glazed curved side panels/ fixed back panel. Front/side base in plastisol black steel (BS 00E53). Controls to customer side. Lift off front service panel, lockable castors, 3m lead, 13A 230v UK plug.

Assisted Service Cold Patisserie (Rear Doors)

Code	Description	Dimensions (L x D x H mm)	Refrig. Airflow Air In/Out	Weight (kg)	Power Rating (kW)
PC6ASHT	D.line A.Serve Cold Patiss. (R.Doors) 600mm	600 x 750 x 1405	In Customer/ Out Operator	144	1.17
PC9ASHT	D.line A.Serve Cold Patiss. (R.Doors) 900mm	900 x 750 x 1405	In Operator/ Out Operator	191	1.36
PC12ASHT	D.line A.Serve Cold Patiss. (R.Doors) 1200mm	1200 x 750 x 1405	In Operator/ Out Operator	243	1.57
PC15ASHT	D.line A.Serve Cold Patiss. (R.Doors) 1500mm	1500 x 750 x 1405	In Operator/ Out Operator	298	1.71
PC18ASHT	D.line A.Serve Cold Patiss. (R.Doors) 1800mm	1800 x 750 x 1405	In Operator/ Out Operator	349	1.76

Model Description. Designline ass. serve cold patiss. front curved glass, 6/9/12/15/1800 (l) x 750(d) x 1405/1415 (h), rear doors, chilled glass shelves (3) c/w ticket strips, display deck area (1), fan blown, hydrocarbon r290 energy efficient refrigeration, LED lighting each tier, colour 4000k. Auto-defrost, 24 hour operation, auto evap condensate tray, glazed curved side panels, d/ glazed rear doors. Base in plastisol steel, colour black (BS 00E53). Controls to operator side. Lift off rear service panel, lockable adj. height castors, 3m lead, 13A 230v UK plug.

Tel : 01254 238 282

CED Fabrications Limited (Head Office), Units A1-A4 Falcon Court
Clayton Business Park, Clayton-Le-Moors, Hyndburn, Lancashire BB5 5JD

www.cedfabsltd.co.uk

sales@cedlimited.com



Std. Airflow
(Except PC6HT)



Std. Airflow
(Except PC6FBHT)



Std. Airflow
(except PC6ASHT)



Designline Serve Over Cold Patisserie

OPTIONS & DIMENSIONS



Option: Control Customer Side

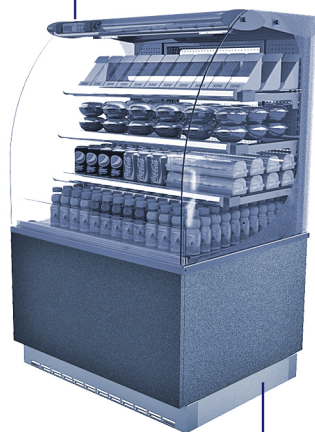

Option: Kickplinth (Set)

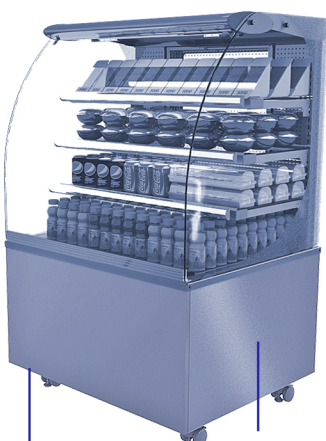

Option: Steel Side Panels

Option: Steel Front Fascia Panel

Kick Plinth: (S/Steel Satin Finish - Set)

Code	Description	Dimensions (Height mm)	Weight (kg)
PKICK6C	Kickplinth (S/Steel Satin Finish) Set (4)	105	1.8
PKICK9C	Kickplinth (S/Steel Satin Finish) Set (4)	105	2
PKICK12C	Kickplinth (S/Steel Satin Finish) Set (4)	105	3
PKICK15C	Kickplinth (S/Steel Satin Finish) Set (4)	105	4
PKICK18C	Kickplinth (S/Steel Satin Finish) Set (4)	105	5.5

(All Cold Patisseries)

Option Description.

Set of stainless steel kickplinths, magnet mounted fastening to base. Satin s/steel finish.

Gantry Controls (To Customer Side)

Code	Description	For Model (Code)
CUSP6	600 Controls To Customer Side (Self Help Patiss. Doors)	PC6HT
CUSP9	900 Controls To Customer Side (Self Help Patiss. Doors)	PC9HT
CUSP12	1200 Controls To Customer Side (Self Help Patiss. Doors)	PC12HT
CUSP15	1500 Controls To Customer Side (Self Help Patiss. Doors)	PC15HT
CUSP18	1800 Controls To Customer Side (Self Help Patiss. Doors)	PC18HT

(Self Help Cold Patisserie)

Controls to customer side gantry: In lieu of std. operator side position.

Front Fascia Panel (S/Steel Satin Finish)

Code	Description	For Models (Code)
KCSF6	600 Front Panel - Vented	PC6HT - PC6ASHT - PC6FBHT
KCSF9	900 Front Panel - Vented	PC9FBHT
KCSF12	1200 Front Panel - Vented	PC12FBHT
KCSF15	1500 Front Panel - Vented (2 Part)	PC15FBHT
KCSF18	1800 Front Panel - Vented (2 Part)	PC18FBHT
KASF9	900 Front Panel - Solid	PC9HT - PC9ASHT
KASF12	1200 Front Panel - Solid	PC12HT - PC12ASHT
KASF15	1500 Front Panel - Solid (2 Part)	PC15HT - PC15ASHT
KASF18	1800 Front Panel - Solid (2 Part)	PC18HT - PC18ASHT

(All Cold Patisseries)

Option Description.

Stainless steel front fascia panel, (in lieu of std. black front panel). Supplied ventilated or solid to suit particular model airflow. Satin s/steel finish.

Side Panels (Set) (S/Steel Satin Finish)

Code	Description	For Models
KSSP	Side Panels (S/Steel: Satin) Set (2)	All Cold Models

(All Cold Patisseries)

Option Description.

Stainless steel side panels, (in lieu of std. black side panels). Set of 2. Satin s/steel finish.

Airflows (Plan View)

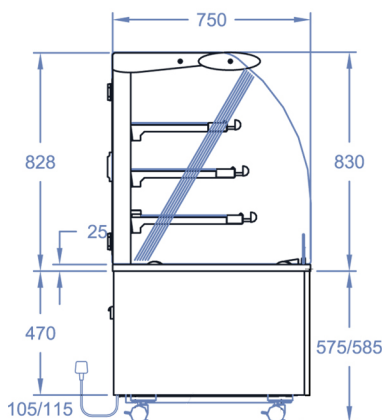

Cold Patisserie
(Rear Door) - PC9HT Shown

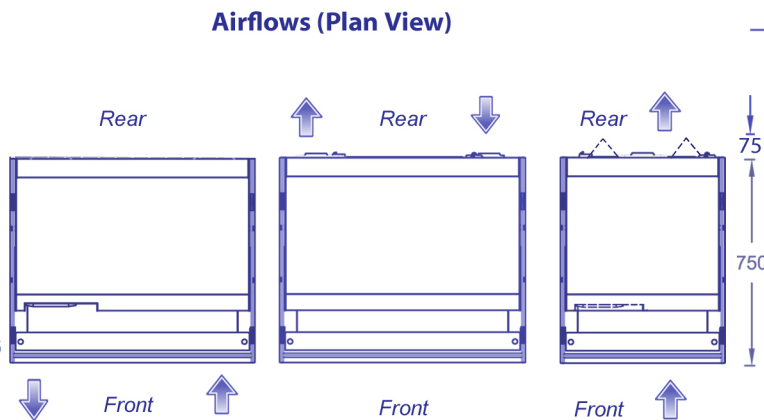

Cold Patisserie
(Fixed Back)
900-1200-1500-1800

Cold Patisserie
(Rear Doors)
900-1200-1500-1800

Cold Patisserie
(Fixed Back/
Rear Doors)
600

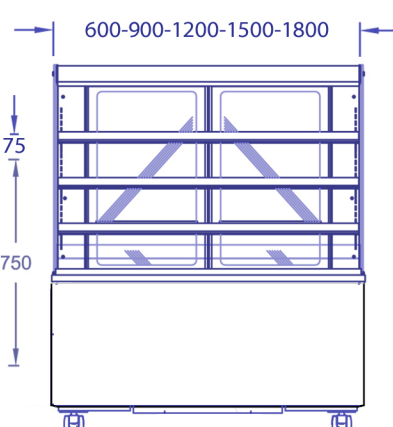

Cold Patisserie
(Rear Door) - PC12HT Shown

